

DADO ESAGONALE ALTO RESISTENZA 8.8

| CODICE | FILETTO | A | B | CODICE | FILETTO | A | B |
|------------|------------|----|----|------------|-----------|----|----|
| JR21001001 | M4 x 0,7 | 7 | 4 | JR21001018 | M22 x 1,5 | 32 | 22 |
| JR21001002 | M5 x 0,8 | 8 | 5 | JR21001019 | M22 x 2,5 | 32 | 22 |
| JR21001003 | M6 x 1 | 10 | 6 | JR21001020 | M24 x 2 | 36 | 24 |
| JR21001004 | M8 x 1,25 | 13 | 8 | JR21001021 | M24 x 3 | 36 | 24 |
| JR21001005 | M10 x 1,25 | 17 | 10 | JR21001022 | M27 x 2 | 41 | 27 |
| JR21001006 | M10 x 1,5 | 17 | 10 | JR21001023 | M27 x 3 | 41 | 27 |
| JR21001007 | M12 x 1,25 | 19 | 12 | JR21001024 | M30 x 2 | 46 | 30 |
| JR21001008 | M12 x 1,5 | 19 | 12 | JR21001025 | M30 x 3,5 | 46 | 30 |
| JR21001009 | M12 x 1,75 | 19 | 12 | JR21001026 | M33 x 2 | 50 | 33 |
| JR21001010 | M14 x 1,5 | 22 | 14 | JR21001027 | M33 x 3,5 | 50 | 33 |
| JR21001011 | M14 x 2 | 22 | 14 | JR21001028 | M36 x 3 | 55 | 36 |
| JR21001012 | M16 x 1,5 | 24 | 16 | JR21001029 | M36 x 4 | 55 | 36 |
| JR21001013 | M16 x 2 | 24 | 16 | JR21001030 | M39 x 3 | 60 | 39 |
| JR21001014 | M18 x 1,5 | 27 | 18 | JR21001031 | M39 x 4 | 60 | 39 |
| JR21001015 | M18 x 2,5 | 27 | 18 | JR21001032 | M42 x 3 | 65 | 42 |
| JR21001016 | M20 x 1,5 | 30 | 20 | JR21001033 | M42 x 4,5 | 65 | 42 |
| JR21001017 | M20 x 2,5 | 30 | 20 | | | | |

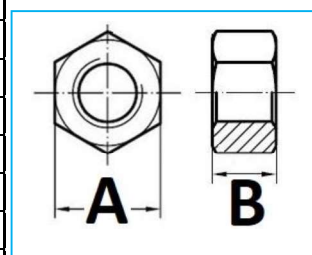

DADO ESAGONALE AUTOBLOCCANTE RESISTENZA 8.8

| CODICE | FILETTO | A | B | CODICE | FILETTO | A | B |
|------------|------------|----|------|------------|-----------|----|------|
| JR21002001 | M4 x 0,7 | 7 | 6 | JR21002017 | M20 x 2,5 | 30 | 23 |
| JR21002002 | M5 x 0,8 | 8 | 6,8 | JR21002018 | M22 x 1,5 | 32 | 25 |
| JR21002003 | M6 x 1 | 10 | 7,8 | JR21002019 | M22 x 2,5 | 32 | 25 |
| JR21002004 | M8 x 1,25 | 13 | 10,6 | JR21002020 | M24 x 2 | 36 | 28 |
| JR21002005 | M10 x 1,25 | 17 | 12,3 | JR21002021 | M24 x 3 | 36 | 28 |
| JR21002006 | M10 x 1,5 | 17 | 12,3 | JR21002022 | M27 x 2 | 41 | 30,8 |
| JR21002007 | M12 x 1,25 | 19 | 14,8 | JR21002023 | M27 x 3 | 41 | 30,8 |
| JR21002008 | M12 x 1,5 | 19 | 14,8 | JR21002024 | M30 x 2 | 46 | 33,2 |
| JR21002009 | M12 x 1,75 | 19 | 14,8 | JR21002025 | M30 x 3,5 | 46 | 33,2 |
| JR21002010 | M14 x 1,5 | 22 | 16,6 | JR21002026 | M33 x 2 | 50 | 36 |
| JR21002011 | M14 x 2 | 22 | 16,6 | JR21002027 | M33 x 3,5 | 50 | 36 |
| JR21002012 | M16 x 1,5 | 24 | 18 | JR21002028 | M36 x 3 | 55 | 40 |
| JR21002013 | M16 x 2 | 24 | 18 | JR21002029 | M36 x 4 | 55 | 40 |
| JR21002014 | M18 x 1,5 | 27 | 21 | JR21002030 | M39 x 3 | 60 | 42 |
| JR21002015 | M18 x 2,5 | 27 | 21 | JR21002031 | M39 x 4 | 60 | 42 |
| JR21002016 | M20 x 1,5 | 30 | 23 | JR21002032 | M42 x 3 | 65 | 45 |
| | | | | JR21002033 | M42 x 4,5 | 65 | 45 |

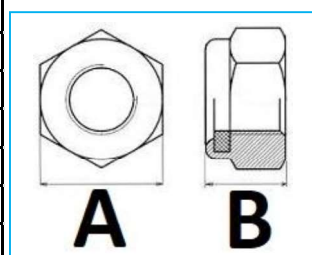

NB: LE MISURE SONO IN "mm".